

INPUT HOLLOW SHAFT DETAIL			
NMRV-(A)	ØIS	IK	IKL
040	14	5	16.3
050	19	6	21.8
063	19	6	21.8
075	24	8	27.3
090	28	8	31.3
110	28	8	31.3
130	38	10	41.3

OUTPUT HOLLOW SHAFT DETAIL			
NMRV-(A)	ØOS	OK	OKL
040	18	6	20.8
050	25	8	28.3
063	25	8	28.3
075	28	8	31.3
090	35	10	38.3
110	42	12	45.3
130	45	14	48.8

NMRV-(A)	OC	O	FC	F	L	h	ØD-h8	ØD1	W	W1	W2	ØS	HC1	HC2	HC3	HC4	TAP	TAP	DEEP
																	M	ØPCD	U
040	71.5	50	70	50	100	121.5	60	87	78	73	71	6.5	70	60	55	35	M6	75	8
050	84	60	80	60	121	144	70	100	92	87	85	8.5	80	70	64	40	M8	85	10
063	102	72	95	72	146	174	80	110	112	106	103	8.5	100	85	80	50	M8	95	14
075	119	86	112.5	86	174	206	95	140	120	114	112	11.5	120	72	93	60	M8	115	14
090	135	103	129.5	103	208	238	110	160	140	134	130	13	140	100	102	70	M10	130	18
110	167.5	127.5	160	127.5	252.5	295	130	200	155	148	144	14	170	115	125	85	M10	165	18
130	187.5	147.5	180	147.5	292.5	335	180	250	170	162	155	16	200	120	140	100	M12	215	21

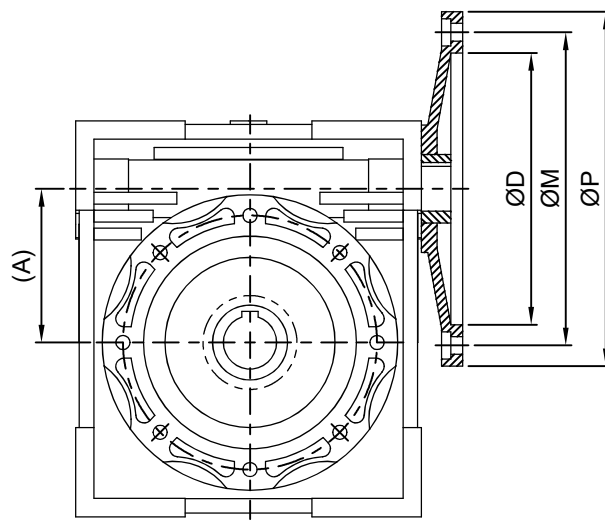

MOTOR FLANGE DETAIL

IEC	NMRV (A)	ØD	ØM	ØP
56-B5	030	80	100	120
	040			
63-B5	030	95	115	140
	040			
	050			
71-B5	040	110	130	160
	050			
	063			
80-B5	050	130	165	200
	063			
	075			
	090			
90-B5	063	130	165	200
	075			
	090			
	110			
100/112-B5	075	180	215	250
	090			
	110			
	130			
	150			
132-B5	110	230	265	300
	130			
	150			
160-B5	150	250	300	350